

The Harlow



3 BEDROOMS • 2 BATHROOMS • 1,572 SQUARE FEET*



CLASSICAL



COTTAGE



COTTAGE II



PRAIRIE

*varies by elevation



WE MAKE BUILDING EASY®. When you build a Veridian home, you get much more than a home designed around you and your dreams. You get the peace of mind that comes with nationally-recognized, award-winning, quality craftsmanship and energy efficiency. You get a home that's constructed using innovative building materials as well as the newest technology and building practices. The result is a high-performing, green and energy efficient home that's a healthier home for you and your pocketbook. And when you build with Veridian Homes, you build with a team of specifically trained experts who make homebuilding easy.

Dream. Build. Live.

DESIGN STUDIO: 6801 South Towne Drive | PHONE: 1.800.726.7397 | WEB: VeridianHomes.com

First Floor

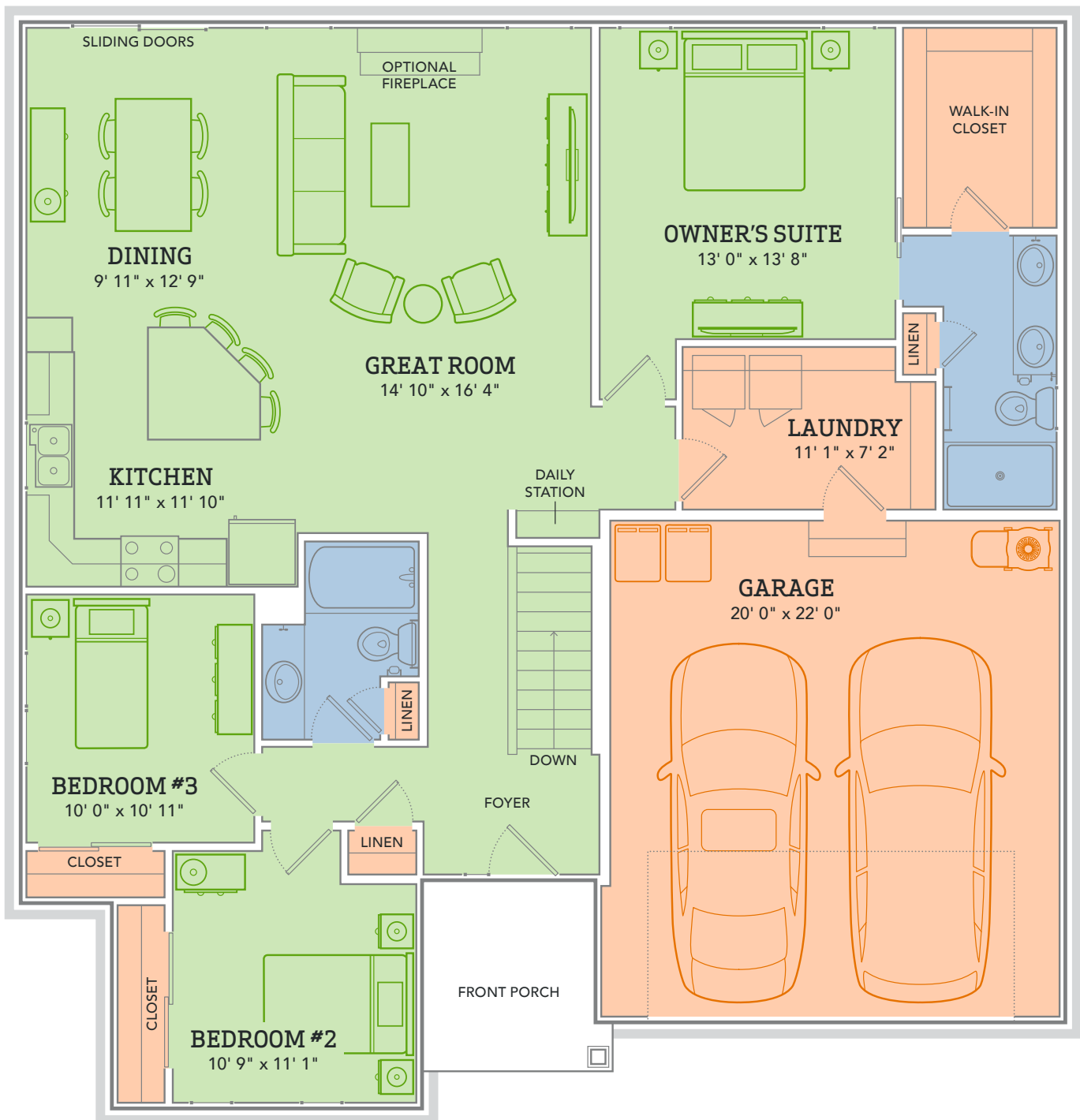

The Harlow

ONE LOOK AT THE OWNER'S SUITE IN THE HARLOW AND YOU'LL FEEL YOUR PULSE QUICKEN... Featuring a private bath and a closet big enough to dance in. The kitchen showcases a large island for entertaining and a sunny set of patio doors for a quiet cup of coffee before your busy day begins.

Features

- Kitchen open to living and dining areas
- Large, triangular kitchen island
- First floor laundry/mudroom
- Owner's suite with double vanity, walk-in closet and linen closet
- Stairs open to lower level
- Custom Auburn Ridge® cabinetry
- Full basement
- Smart Home+ technology
- Energy expert certified
- Award-winning, high-performance home

Options

- Nine foot ceilings
- Cathedral, vault and tray ceiling options
- Finished basement
- Tile shower or soaking tub in owner's suite
- Custom built-ins
- Personalized closet systems
- Additional green materials/products
- Personalize your home with thousands of options found within our Design Studio



CERTIFIED HIGH-PERFORMING HOMES
BUILDING ENERGY EFFICIENT, GREEN HOMES SINCE 2001

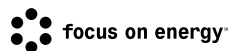

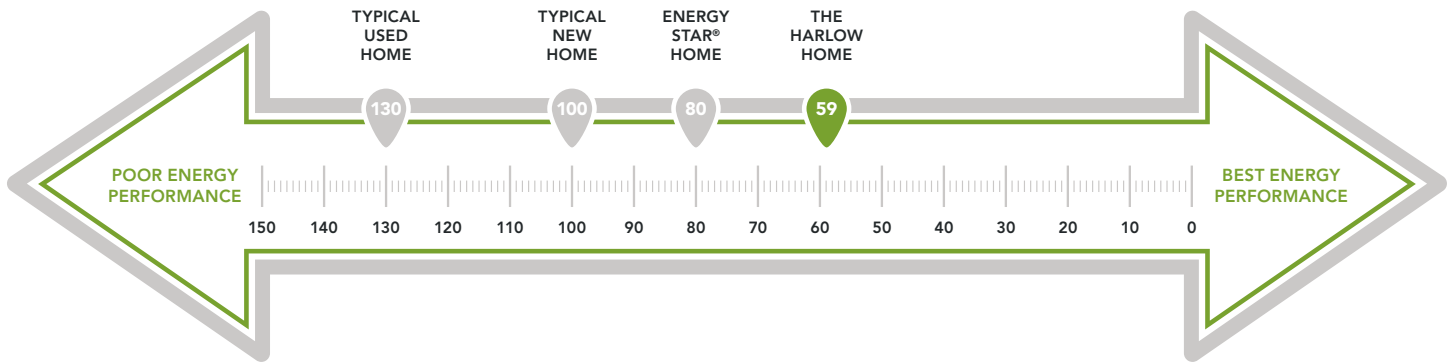

**\$193
IN SAVINGS**

ESTIMATED AVERAGE MONTHLY ENERGY BILL SAVINGS WITH THE HARLOW*

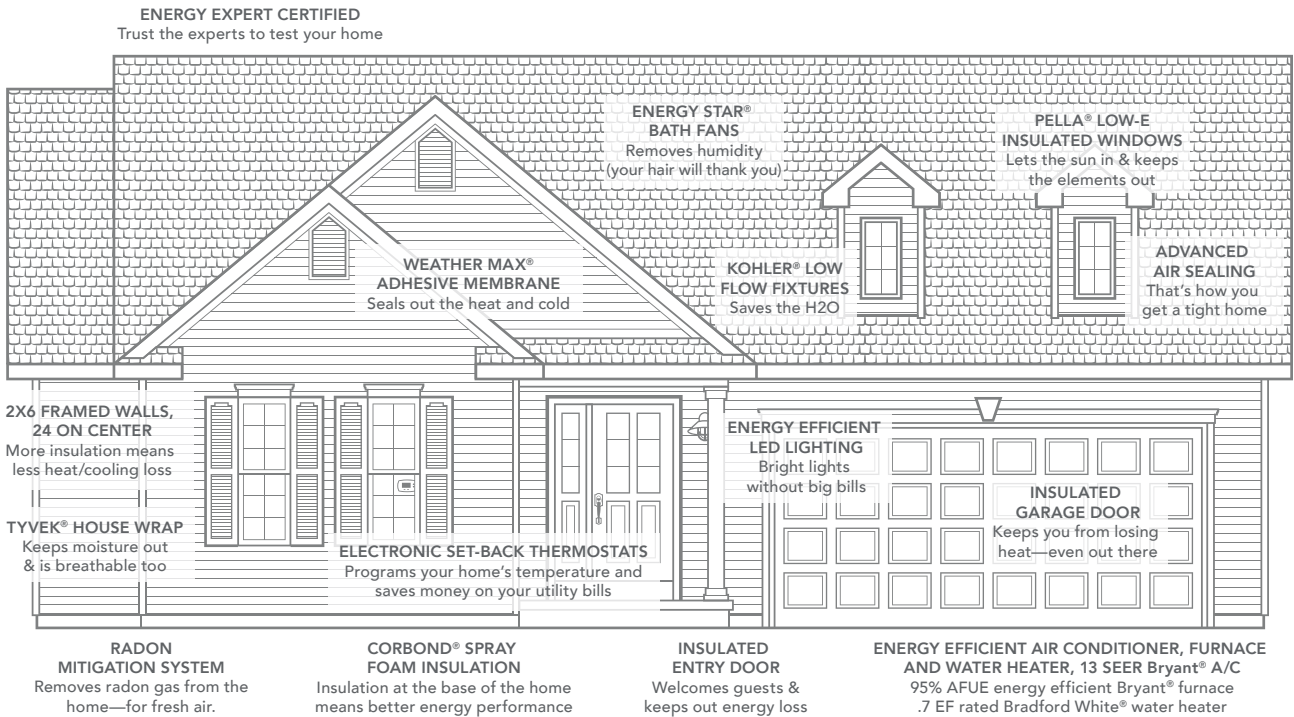

A LOOK INSIDE THE HARLOW'S ENERGY EFFICIENCY. Each point decrease in the HERS Index means a 1% reduction in energy consumption. Based on this, the Harlow is 71% more energy efficient than a typical used home. The HERS Index is a scoring system created by the Residential Energy Services Network (RESNET), and provides comparable energy efficiencies in various homes. Only a RESNET certified independent energy rater can determine a home's score. This energy scale is based on the U.S. Department of Energy's EnergySmart Home Scales. Actual energy savings may vary depending on a number of factors including the number of people living in the household, consumption habits, age/condition of electronics and appliances used, and lifestyle; and are not guaranteed.

*Estimated average monthly energy bill savings with the Harlow. The costs were calculated using REM/Rate™ 12.97 and the HERS Score for the reference homes listed in the arrow chart and were published by RESNET, as compared to the typical used home. The typical used and new home scores were determined by the U.S. Department of Energy.