

# The Brody



3 BEDROOMS • 2 BATHROOMS • 1,589 SQUARE FEET\*



TRADITIONAL



COTTAGE



CRAFTSMAN

\*varies by elevation



**WE MAKE BUILDING EASY®.** When you build a Veridian home, you get much more than a home designed around you and your dreams. You get the peace of mind that comes with nationally-recognized, award-winning, quality craftsmanship and energy efficiency. You get a home that's constructed using innovative building materials as well as the newest technology and building practices. The result is a high-performing, green and energy efficient home that's a healthier home for you and your pocketbook. And when you build with Veridian Homes, you build with a team of specifically trained experts who make homebuilding easy.

*Dream. Build. Live.*

DESIGN STUDIO: 6801 South Towne Drive | PHONE: 1.800.726.7397 | WEB: VeridianHomes.com

First Floor

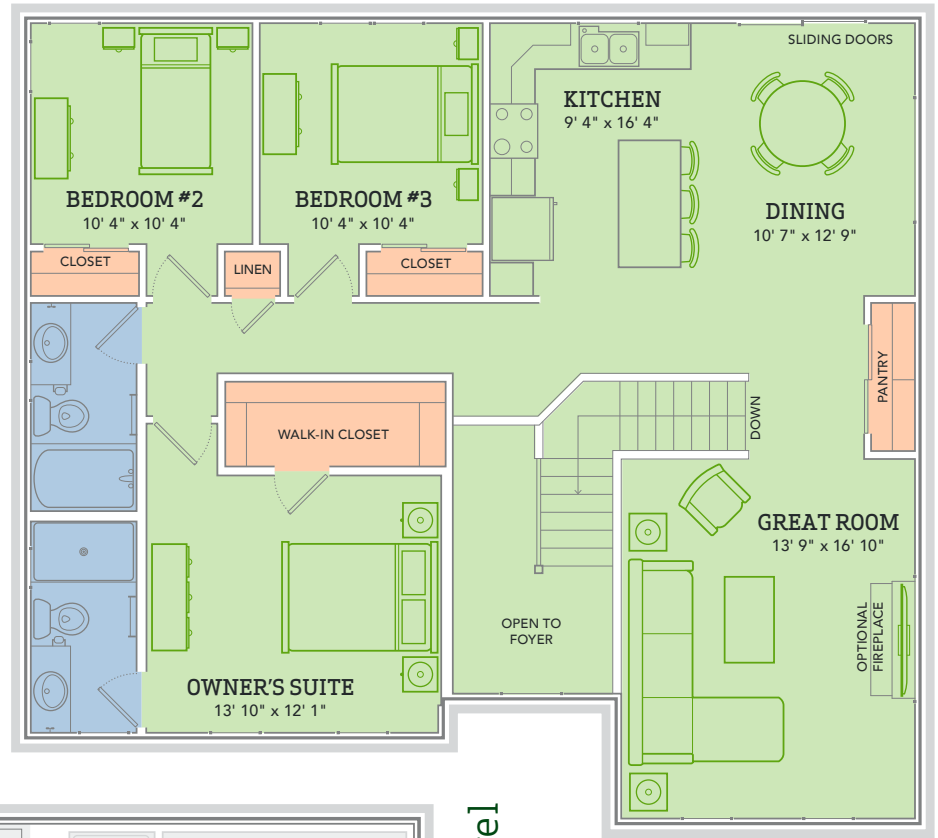

Lower Level

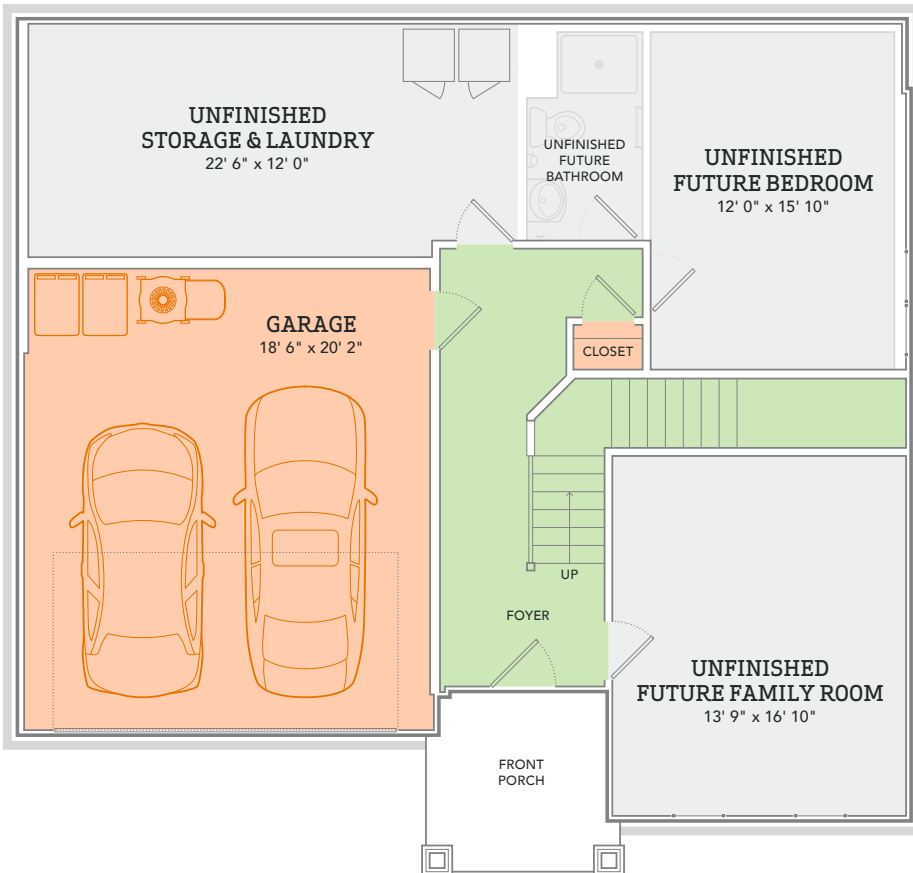

## The Brody

**YOU BEND BACKWARDS FOR EVERYONE ELSE.**

Why not let The Brody get this one for you? Fitting into your life and your needs, not the other way around. The open concept kitchen and dining space creates the perfect oasis for planning your day. With the future lower level space options, there is potential aplenty, just inside your front door. Welcome to The Brody.

## Features

- Raised ranch home with open foyer
- Kitchen open to dining area
- Kitchen island with breakfast bar
- Custom Auburn Ridge® cabinetry
- Owner's suite with walk-in closet and private bath
- Built-in Daily Station off kitchen
- Smart Home+ technology
- Energy expert certified
- Award-winning, high-performance home

## Options

- Cathedral and tray ceiling options
- Custom built-ins
- Butler's pantry, wine or coffee bar
- Personalized closet systems
- Whirlpool and soaking tub options
- Additional green materials/products
- Personalize your home with thousands of options found within our Design Studio



\*features from a similar model

**CERTIFIED HIGH-PERFORMING HOMES**  
BUILDING ENERGY EFFICIENT, GREEN HOMES SINCE 2001

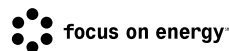

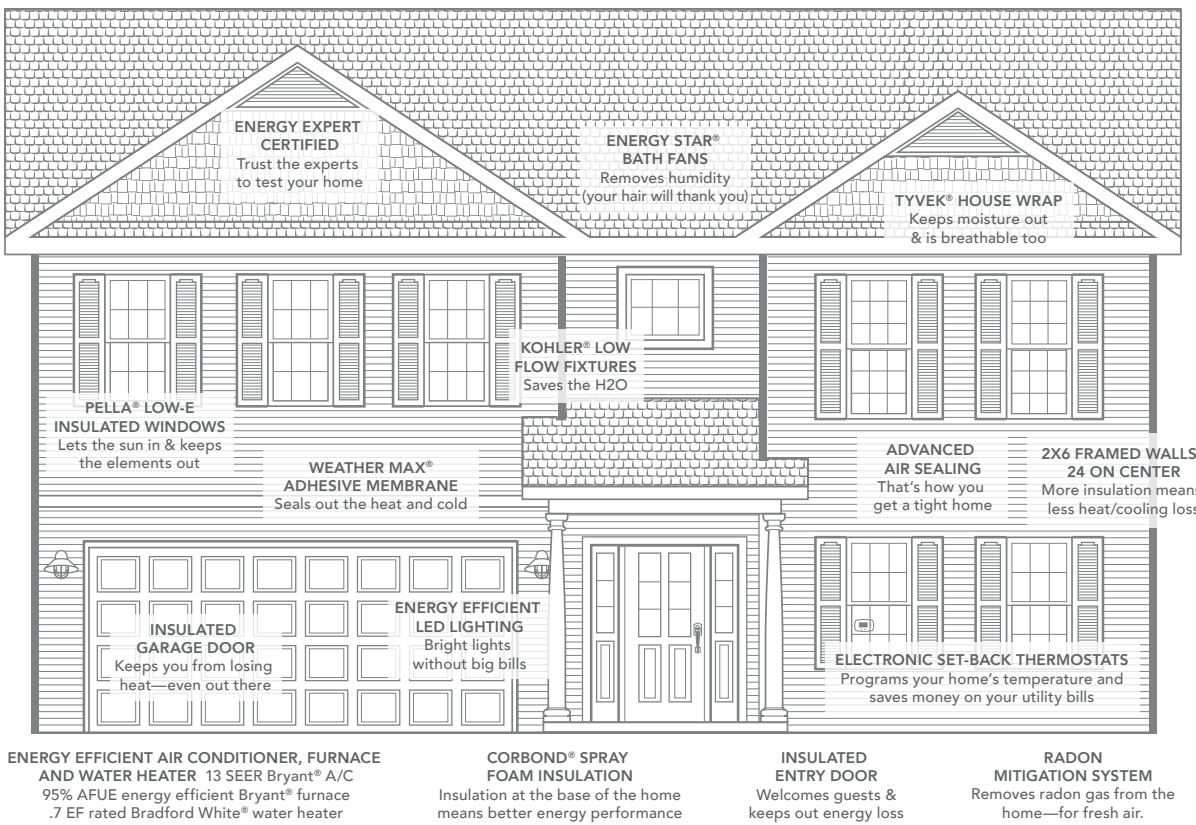
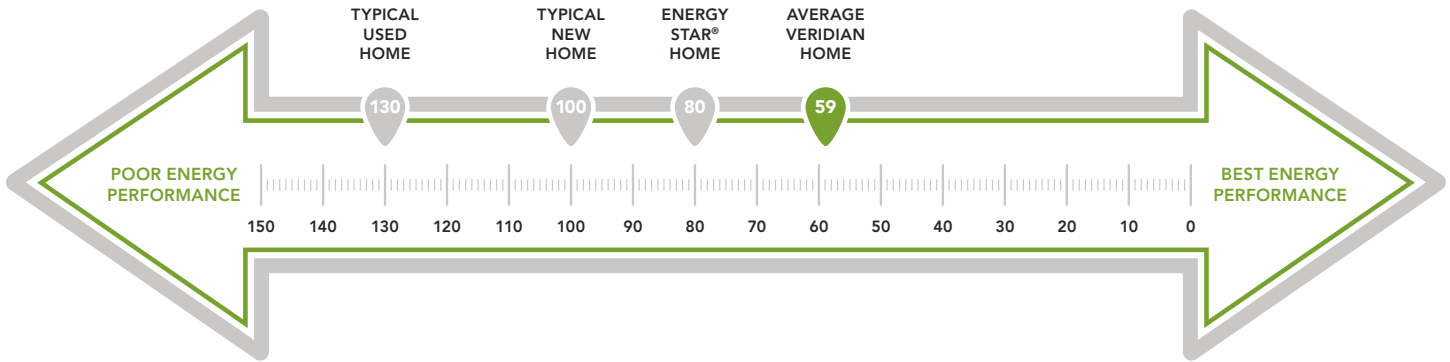

**\$182**  
IN SAVINGS

ESTIMATED AVERAGE MONTHLY ENERGY BILL SAVINGS WITH THE BRODY\*

**A LOOK INSIDE THE BRODY'S ENERGY EFFICIENCY.** Each point decrease in the HERS Index means a 1% reduction in energy consumption. Based on this, the Brody is 70% more energy efficient than a typical used home. The HERS Index is a scoring system created by the Residential Energy Services Network (RESNET), and provides comparable energy efficiencies in various homes. Only a RESNET certified independent energy rater can determine a home's score. This energy scale is based on the U.S. Department of Energy's EnergySmart Home Scales. Actual energy savings may vary depending on a number of factors including the number of people living in the household, consumption habits, age/condition of electronics and appliances used, and lifestyle; and are not guaranteed.

\*Estimated average monthly energy bill savings with the Brody. The costs were calculated using REM/Rate™ 12.97 and the HERS Score for the reference homes listed in the arrow chart and were published by RESNET, as compared to the typical used home. The typical used and new home scores were determined by the U.S. Department of Energy.