

The Jackson



4 BEDROOMS · 2.5 BATHROOMS · 2,781 SQUARE FEET*



*varies by elevation

WE MAKE BUILDING EASY®

When you build a Veridian home, you get much more than a home designed around you and your dreams. You get the peace of mind that comes with nationally-recognized, award-winning, quality craftsmanship and energy efficiency. You get a home that's constructed using innovative building materials as well as the newest technology and building practices. The result is a high-performing, green and energy efficient home that's a healthier home for you and your pocketbook. And when you build with Veridian Homes, you build with a team of specifically trained experts who make homebuilding easy. *So go ahead. Dream. Build. Live.*

Dream. Build. Live.

DESIGN STUDIO: 6801 South Towne Drive | PHONE: 1.800.726.7397 | WEB: VeridianHomes.com



Second Floor

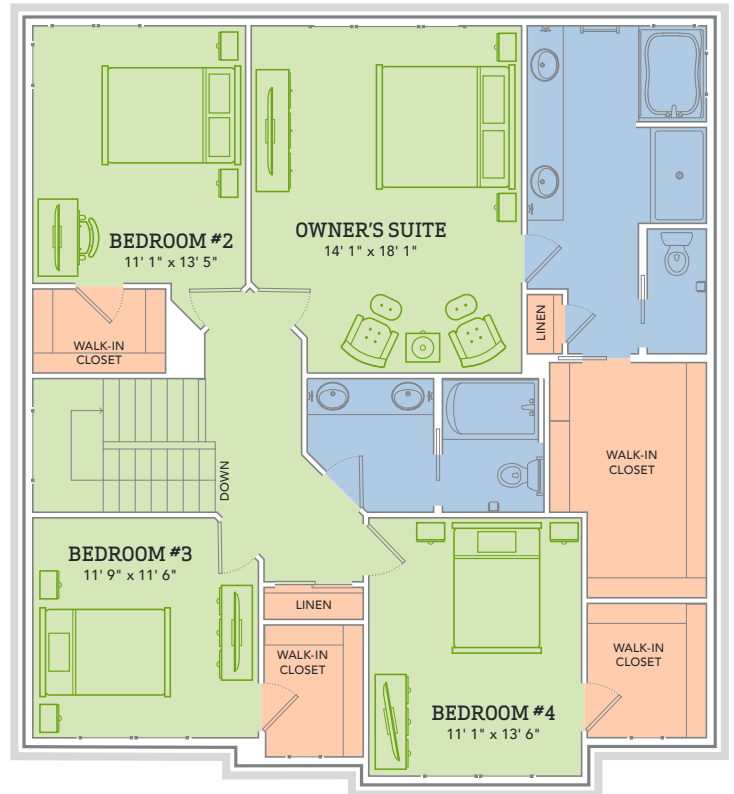
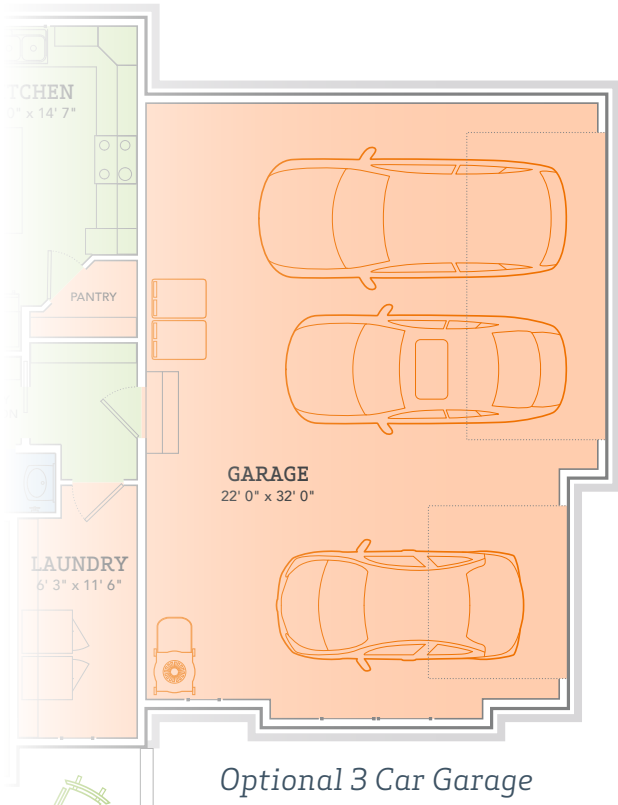

WITH ITS DRAMATIC TWO-STORY FOYER, there's no denying The Jackson makes a statement. Actually, it makes several. Its four bedrooms say there's plenty of room for everyone. Its spacious owner's suite acknowledges there's a time for peace and privacy. Its loft makes a case for a unique imagination and inspiration space. Its big basement – ready to finish off or leave as is – understands that sometimes, kids just need to be roughhousing kids. And The Jackson's biggest statement? It says "welcome home."

Features

- Open family living areas
- Formal dining room and dinette off the kitchen
- Flex room for office, playroom, etc.
- Large kitchen island / breakfast bar
- Fireplace in great room
- Custom Auburn Ridge® cabinetry
- Spacious first floor laundry room
- Soaking tub in owner's bathroom
- Nine foot ceilings on the first floor
- Foyer open to the second floor
- Smart Home+ technology
- Energy expert certified
- Award-winning, high-performance home

Options

- Loft or fifth bedroom
- Tray ceiling options
- Custom built-in bookcases, desks, etc.
- Butler's pantry and/or wine bar
- Additional green materials/products
- Deck, patio or screened porch
- Whirlpool and soaking tub options
- Three-car garage, dependent upon homesite
- Personalize your home with thousands of options found within our Design Studio

Elevations



CERTIFIED HIGH-PERFORMING HOMES
BUILDING ENERGY EFFICIENT, GREEN HOMES SINCE 2001



focus on energy™





VERIDIAN'S HIGH-PERFORMING FEATURES

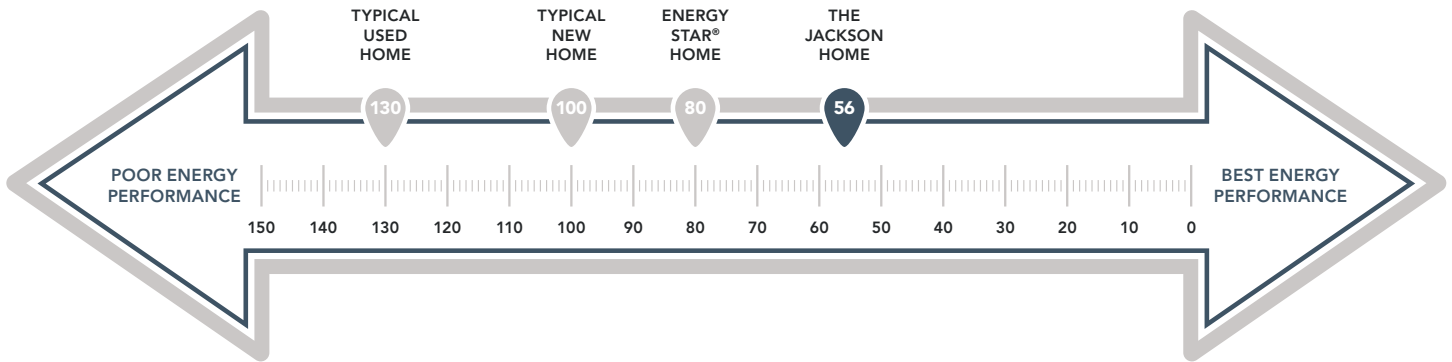

ENERGY STAR® BATH FANS
Removes humidity (your hair will thank you)

KOHLER® LOW FLOW FIXTURES
Saves the H₂O

WEATHER MAX® ADHESIVE MEMBRANE
Seals out the heat and cold

ADVANCED AIR SEALING
That's how you get a tight home

2X6 FRAMED WALLS, 24 ON CENTER
More insulation means less heat/cooling loss

TYVEK® HOUSE WRAP
Keeps moisture out & is breathable too

ELECTRONIC SET-BACK THERMOSTATS
Programs your home's temperature and saves money on your utility bills

VISIONS® INSULATED VINYL WINDOWS
Lets the sun in & keeps the elements out

ENERGY EFFICIENT LED LIGHTING
Bright lights without big bills

INSULATED GARAGE DOORS
Keeps you from losing heat—even out there

RADON MITIGATION SYSTEM
Removes radon gas from the home—for fresh air.

INSULATED ENTRY DOOR
Welcomes guests & keeps out energy loss

CORBOND® SPRAY FOAM INSULATION
Insulation at the base of the home means better energy performance

ENERGY EXPERT CERTIFIED
Trust the experts to test your home

\$259

IN SAVINGS

ESTIMATED AVERAGE MONTHLY ENERGY BILL SAVINGS WITH THE JACKSON*

ENERGY EFFICIENT AIR CONDITIONER, FURNACE AND WATER HEATER
 13 SEER Bryant® A/C
 95% AFUE energy efficient Bryant® furnace
 .7 EF rated Bradford White® water heater

A LOOK INSIDE THE JACKSON'S ENERGY EFFICIENCY.

Each point decrease in the HERS Index means a 1% reduction in energy consumption. Based on this, the Jackson is 73% more energy efficient than a typical used home. The HERS Index is a scoring system created by the Residential Energy Services Network (RESNET), and provides comparable energy efficiencies in various homes. Only a RESNET certified independent energy rater can determine a home's score. This energy scale is based on the U.S. Department of Energy's EnergySmart Home Scales. Actual energy savings may vary depending on a number of factors including the number of people living in the household, consumption habits, age/condition of electronics and appliances used, and lifestyle; and are not guaranteed.

*Estimated average monthly energy bill savings with the Jackson. The costs were calculated using REM/Rate™ 12.97 and the HERS Score for the reference homes listed in the arrow chart and were published by RESNET, as compared to the typical used home. The typical used and new home scores were determined by the U.S. Department of Energy.