

The Becket



4 BEDROOMS • 3.5 BATHROOMS • 3,459 SQUARE FEET*



COTTAGE

*varies by elevation



WE MAKE BUILDING EASY®. When you build a Veridian home, you get much more than a home designed around you and your dreams. You get the peace of mind that comes with nationally-recognized, award-winning, quality craftsmanship and energy efficiency. You get a home that's constructed using innovative building materials as well as the newest technology and building practices. The result is a high-performing, green and energy efficient home that's a healthier home for you and your pocketbook. And when you build with Veridian Homes, you build with a team of specifically trained experts who make homebuilding easy.

Dream. Build. Live.

DESIGN STUDIO: 6801 South Towne Drive | PHONE: 1.800.726.7397 | WEB: VeridianHomes.com

First Floor

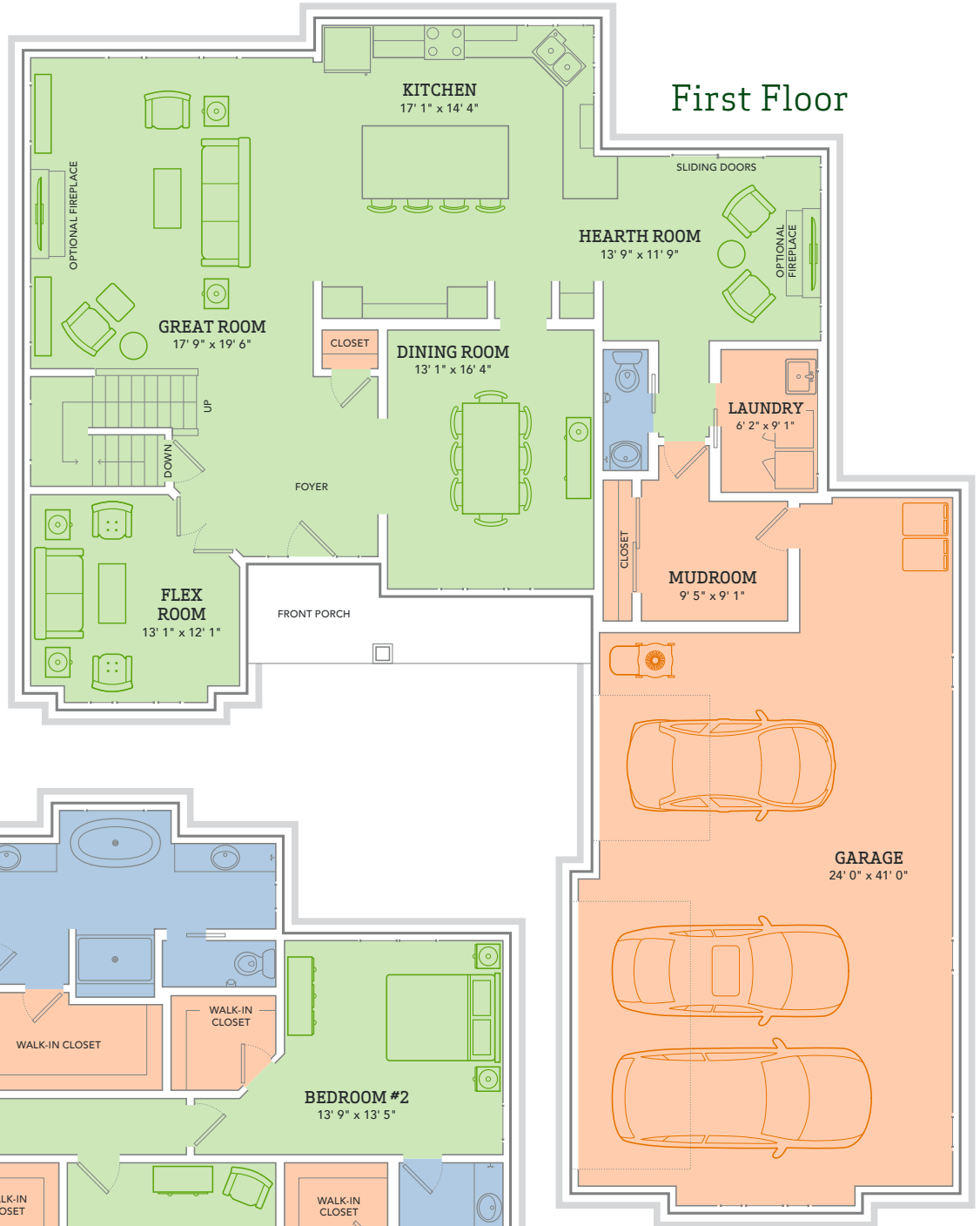

Second Floor

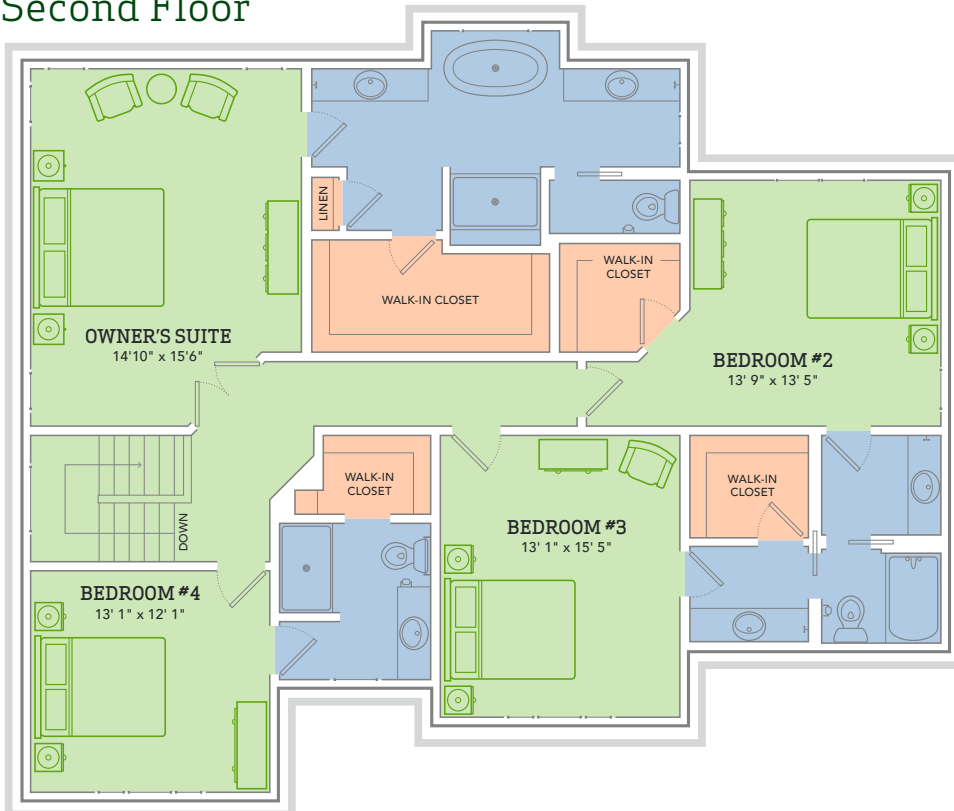

The Becket

A DREAM HOME FOR THE WHOLE FAMILY, THE BECKET WAS CONSTRUCTED WITH YOUR LOVED ONES IN MIND. This immense two-story floor plan features a beautiful hearth room, and a breathtaking owner's suite with both a walk-in shower and a Whirlpool tub. Best of all, no more fighting for closet space; each expansive bedroom includes an attached walk-in closet. Get lost in the vast elegance of the Becket.

Features

- Kitchen open to great room and hearth room
- Separate mudroom and laundry room, located off garage
- Flex room off foyer, for formal dining, office, etc.
- Spacious owner's suite with massive walk-in closet and private bath with freestanding tub
- Nine foot ceilings throughout first floor
- All bedrooms feature access to private bath and walk-in closets
- Zoned heating
- Custom Auburn Ridge® cabinetry
- Smart Home+ technology
- Energy expert certified
- Award-winning high-performance home

Options

- Cathedral, vault and tray ceiling options
- Custom built-ins
- Whirlpool and soaking tub options
- Personalized closet systems
- Additional green materials/products
- Personalize your home with thousands of options found within our Design Studio



*features from a similar model

CERTIFIED HIGH-PERFORMING HOMES
BUILDING ENERGY EFFICIENT, GREEN HOMES SINCE 2001

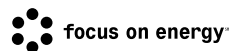

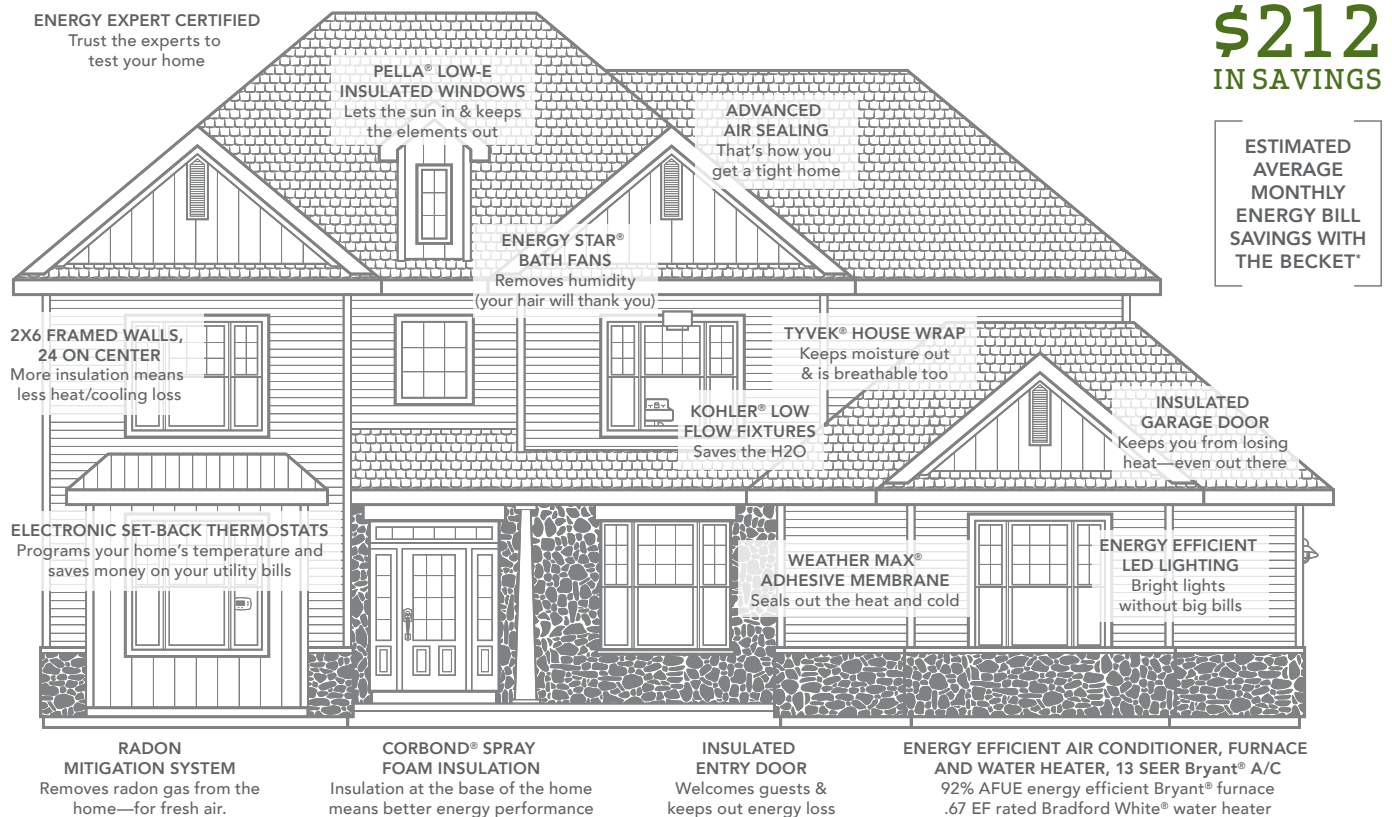
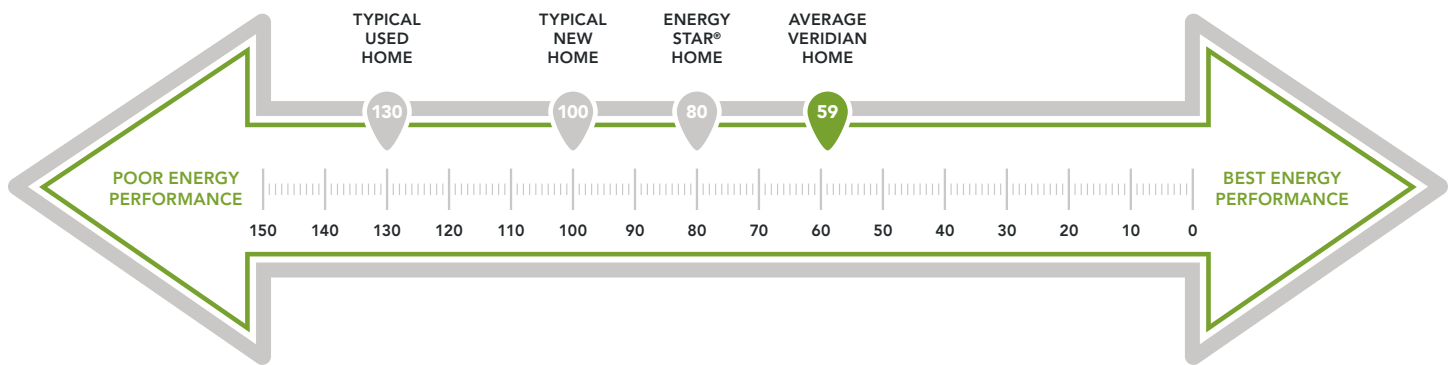

A LOOK INSIDE THE BECKET'S ENERGY EFFICIENCY. Each point decrease in the HERS Index means a 1% reduction in energy consumption. Based on this, the Becket is 74% more energy efficient than a typical used home. The HERS Index is a scoring system created by the Residential Energy Services Network (RESNET), and provides comparable energy efficiencies in various homes. Only a RESNET certified independent energy rater can determine a home's score. This energy scale is based on the U.S. Department of Energy's EnergySmart Home Scales. Actual energy savings may vary depending on a number of factors including the number of people living in the household, consumption habits, age/condition of electronics and appliances used, and lifestyle; and are not guaranteed.

*Estimated average monthly energy bill savings with the Becket. The costs were calculated using REM/Rate™ 12.97 and the HERS Score for the reference homes listed in the arrow chart and were published by RESNET, as compared to the typical used home. The typical used and new home scores were determined by the U.S. Department of Energy.